

NOTES: UNLESS OTHERWISE SPECIFIED

- BATTERY CONFORMS TO THE REQUIREMENTS OF MIL-PRF-8565 AND MIL-PRF-8565/6, QUALIFIED PRODUCTS LISTED.
- SEE DRAWING NO. CB-00235 AND PROCEDURE P-1000 FOR ASSEMBLY AND TEST INSTRUCTION. PROCEDURES AND ASSEMBLY DRAWINGS ARE FOR INTERNAL USE ONLY.
- BATTERY WEIGHT: 2.9 kg MAXIMUM
- FOR DIMENSIONS NOT SHOWN, SEE MILITARY SPECIFICATIONS.

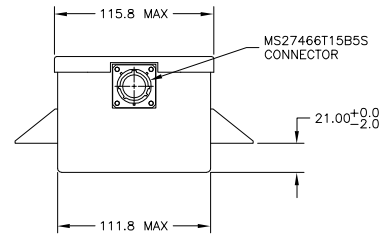
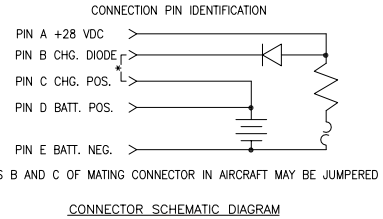
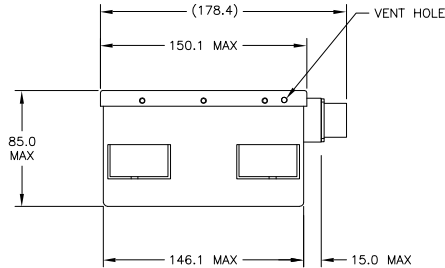
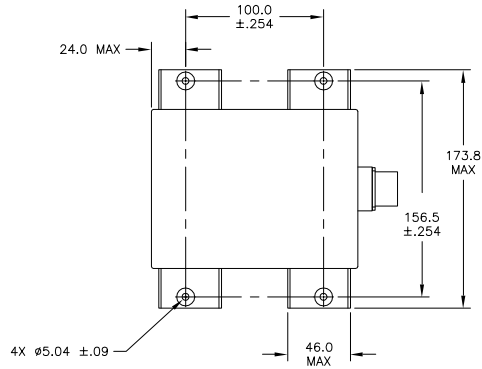

ENVELOPE DRAWING

REV	DESCRIPTION	DATE	APPROVED
A	UPDATED NOTE 1, FIXED CAGE CODE	1/31/03	JBT

QTY	REQD	CAGE CODE	PART OR IDENTIFYING NO.	NOMENCLATURE OR DESCRIPTION	MATERIAL SPECIFICATION	ITEM NO.
PARTS LIST						
UNLESS OTHERWISE SPECIFIED DIMENSIONS ARE IN INCHES TOLERANCES ARE:				CONCORDE BATTERY CORPORATION		
FRACTIONS DECIMALS ANGLES				2009 SAN BERNARDINO RD., W. COVINA, CA 91790		
* JXX #	* JXX #	* JXX #	APPROVALS	DATE	TITLE BATTERY, STORAGE, AIRCRAFT	
			DRAWN B. PORTER	6/28/99	24 VOLT, 1.5 AH	
TREATMENT	CHECKED AMIII	8/6/99	APPROVED JBT	8/10/99	SIZE C	CAGE CODE 63017
FINISH	APPROVED JBT	8/10/99	ISSUED AT	2/6/03	DWG NO. D8565/6-1	REV A
SIMILAR TO	ACT INT	OLD WT	SCALE	1/2	SHEET	1 OF 1

ENGINEERING COPY CBTEB03