

RG-129 Series

24V EMERGENCY BATTERY

for Emergency Lighting & Back Up, Avionics, and More

TSO APPROVED

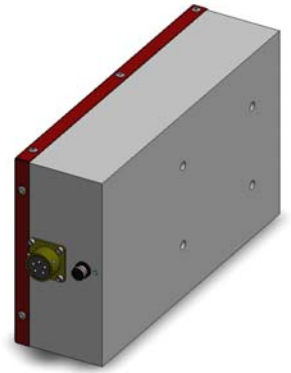

Concorde RG[®] Series emergency batteries protect and extend the life of other avionics and are charged directly from the DC bus with no dedicated charger. This results in a high inrush current which extends battery life with fast recovery time from discharge. With the battery connected directly to the bus, transient spikes in the DC power are absorbed by the battery. Concorde Emergency Batteries are self regulating on charge and use only the current required to maintain them at full charge.

Recombinant Gas - The RG[®] Series are low resistance, valve regulated lead acid (VRLA) batteries.

- Maintenance free
- Constructed with non removable vent valves – no addition of electrolyte or water required
- Non spillable
- Shipped fully charged and ready to install
- Manufactured with absorbed glass mat separators (AGM)
- RG[®] Series batteries are the original AGM battery designed for the U.S. Military
- RG[®] Series batteries ship Hazmat Exempt

RG-129

- Rated Capacity, C1 = 3.8 Ah
- Maximum Weight 11.2 LB / 5.1 KG
- Internal Heater – DC Powered, 4A at 28.25 VDC
- Receptacle MS3122E14-5S
- MS3320 – 7.5 Ah Circuit Breaker

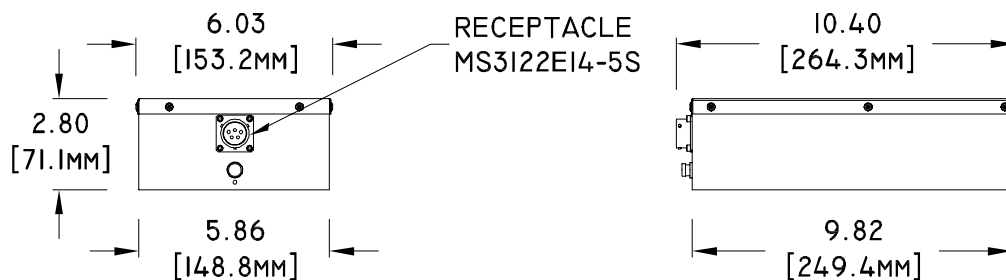

Concorde Battery Corporation is the largest supplier of Original Equipment VRLA Batteries. Over 50 Concorde batteries and accessories are **FAA Approved & TSO Authorized** for installation on more than 1,000 aircraft models.



0808

Concorde Battery Corporation
2009 San Bernardino Road
West Covina, CA, 91790, USA
Phone 626-813-1234 | Fax 626-813-1235
Email: customer-service@concordebattery.com
www.concordebattery.com
ISO 9001:2000 + AS9100B