

RG-120

24V Aircraft Battery for Emergency Lighting, Back Up, Avionics

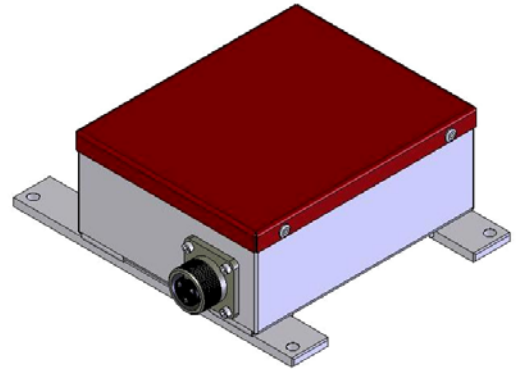

Emergency Battery for lighting, standby, back up power, avionics and FADEC. Protects and extends the life of other avionics. Concorde's Emergency Batteries float directly on the DC buss with no need for a dedicated charger. This results in a high inrush current which extends battery life with fast recovery time from discharge. With the battery floating directly on the buss, transient spikes in the DC power are absorbed. These batteries are self regulating on charge and will take only the current required to maintain it at full charge.

Recombinant Gas - The RG® Series are low resistance, valve regulated lead acid (VRLA) batteries.

- Maintenance free
- Constructed with non removable vent valves - no addition of electrolyte or water required
- Non spillable at any altitude or attitude
- Shipped fully charged and ready to install
- Manufactured with absorbed glass mat separators (AGM)
- RG® Series batteries are the original AGM Battery designed for the U.S. Military
- RG® Series batteries ship Hazmat Exempt

RG-120

- Rated Capacity (C1) 0.70 Ah
- Maximum Weight 3.5 LB / 1.59 KG

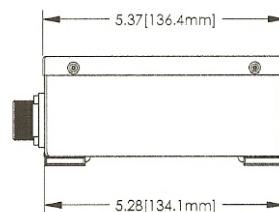
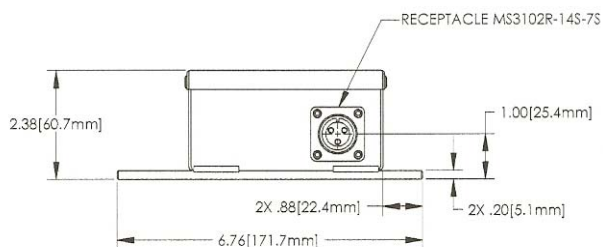

CONNECTION PIN IDENTIFICATION

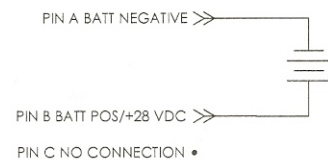

2009 San Bernardino Road
West Covina, CA, 91790 USA
Phone 626-813-1234 | Fax 626-813-1235
www.concordebattery.com
customer-service@concordebattery.com
ISO 9001:2000 + AS9100B