

NOTES: UNLESS OTHERWISE SPECIFIED

1. SEE DRAWING NO. CB-00278 AND PROCEDURE P-1000 FOR ASSEMBLY AND TEST INSTRUCTION. PROCEDURES AND ASSEMBLY DRAWINGS ARE FOR INTERNAL USE ONLY.
2. ALL TESTING IS PERFORMED IAW BATTERY COUNCIL INTERNATIONAL STANDARDS.
3. ALL DIMENSIONS ARE INCH [MM].
4. ABBREVIATION USED IN TITLE IS: ABSORBED GLASS MAT (AGM)

REVISIONS			
REV	DESCRIPTION	DATE	APPROVED
E	SEE DCN AGM12105TE	8/10/11	JBT

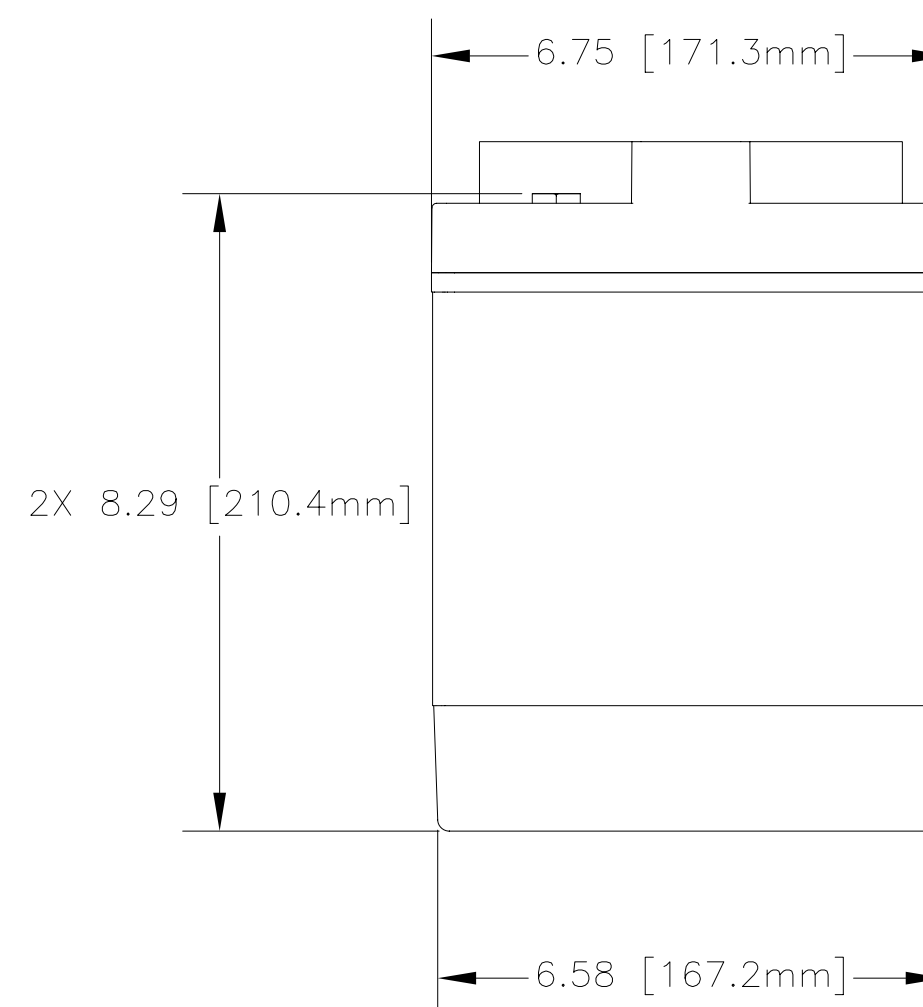
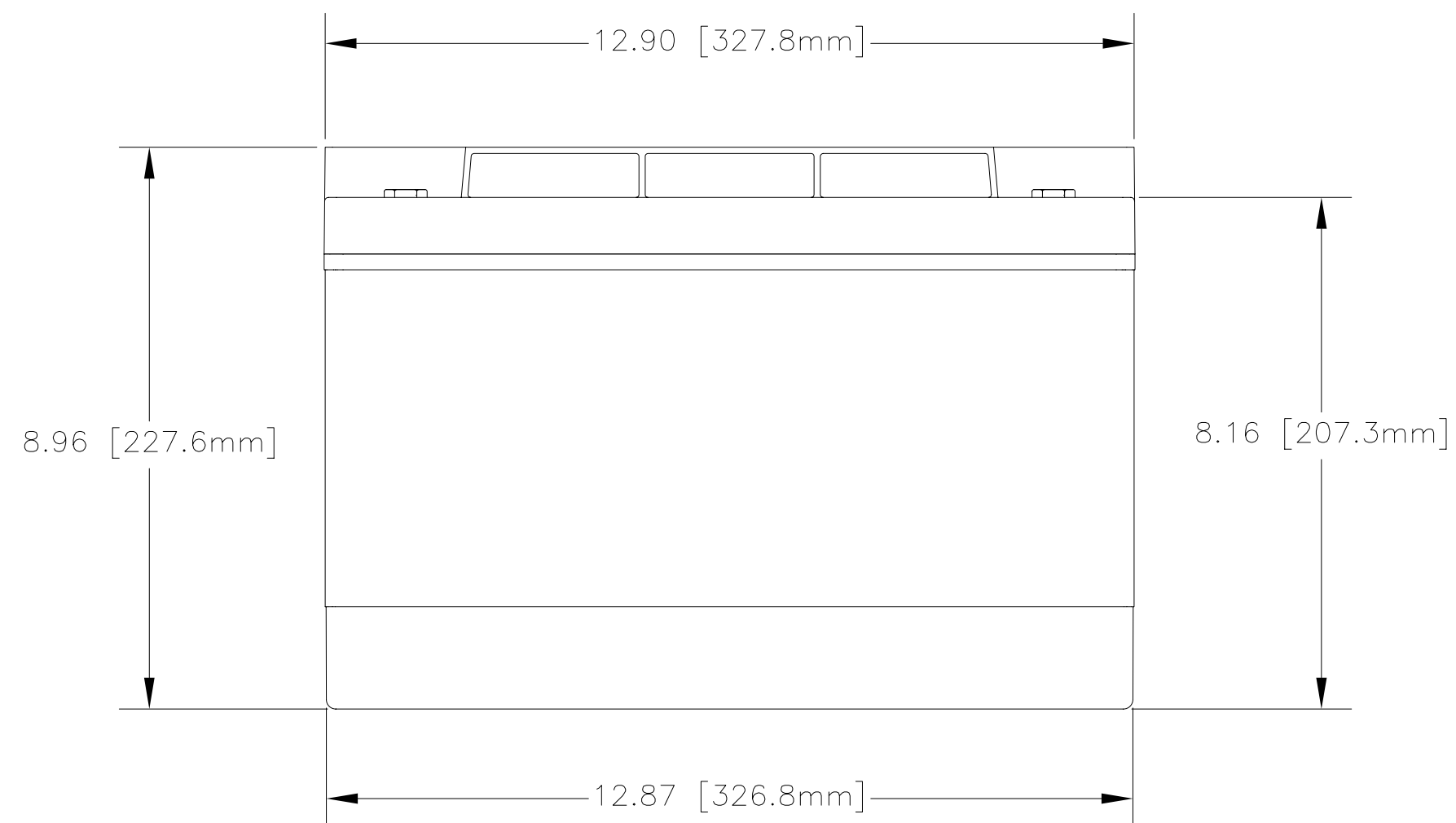
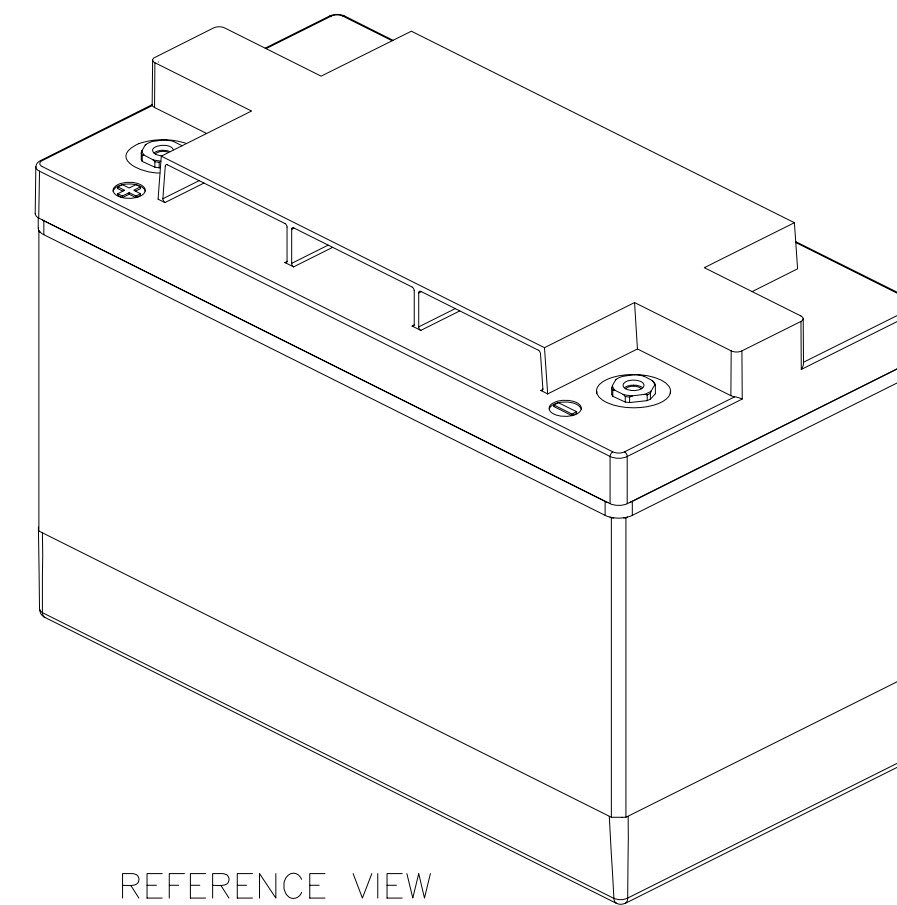
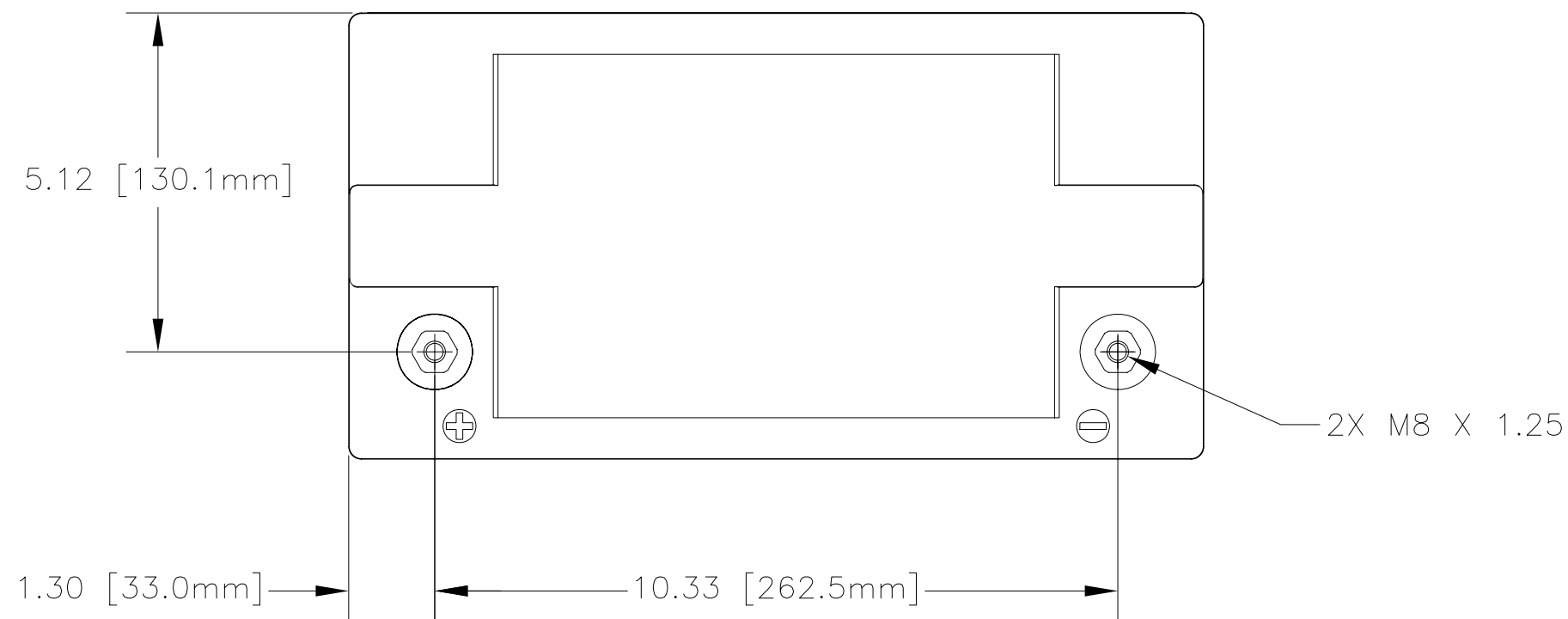

CAPACITY RATINGS

PART NUMBER	AGM-1285T	AGM-12105T
NOMINAL WEIGHT	62 LBS [28.2 KG]	64 LBS [29 KG]
AMPERE HOUR CAPACITY @ 20 HOUR 1.75 VOLTS/CELL @ 77°F (25°C)	85 AH	105 AH
MINUTES OF DISCHARGE @ 25 AMPS 1.75 VOLTS/CELL @ 77°F (25°C)	158 MIN	195 MIN

ENVELOPE DRAWING

QTY REQD	CAGE CODE	PART OR IDENTIFYING NO.	NOMENCLATURE OR DESCRIPTION	MATERIAL SPECIFICATION	ITEM NO.
PARTS LIST					
UNLESS OTHERWISE SPECIFIED DIMENSIONS ARE IN INCHES TOLERANCES ARE: FRACTIONS DECIMALS ANGLES ± 1/32 .XX ± .06 ± 1° .XXX ± .060			CONTRACT NO.	CONCORDE BATTERY CORPORATION 2009 SAN BERNARDINO RD, W. COVINA, CA 91790	
TREATMENT NONE			APPROVALS	DATE	TITLE
FINISH NONE			DRAWN ELH	3/1/00	BATTERY, 12 VOLT, AGM-12105T SERIES
SIMILAR TO			CHECKED S.VALDEZ	3/1/00	SIZE CAGE CODE DWG NO. REV C 63017 AGM-12105T E
ACT WT CALC WT			APPROVED JBT	3/4/00	SCALE NONE SHEET 1 OF 1
			ISSUED JJ	8/12/11	