

NOTES: UNLESS OTHERWISE SPECIFIED

1. SEE DRAWING NO. CB-00278 AND PROCEDURE P-1000 FOR ASSEMBLY AND TEST INSTRUCTION. PROCEDURES AND ASSEMBLY DRAWINGS ARE FOR INTERNAL USE ONLY.
2. ALL TESTING ARE IAW BATTERY COUNCIL INTERNATIONAL STANDARDS.
3. ALL DIMENSIONS ARE IN INCHES [MM].

REVISIONS			
REV	DESCRIPTION	DATE	APPROVED
A	REVISED CAPACITY TABLE	3/15/00	JBT

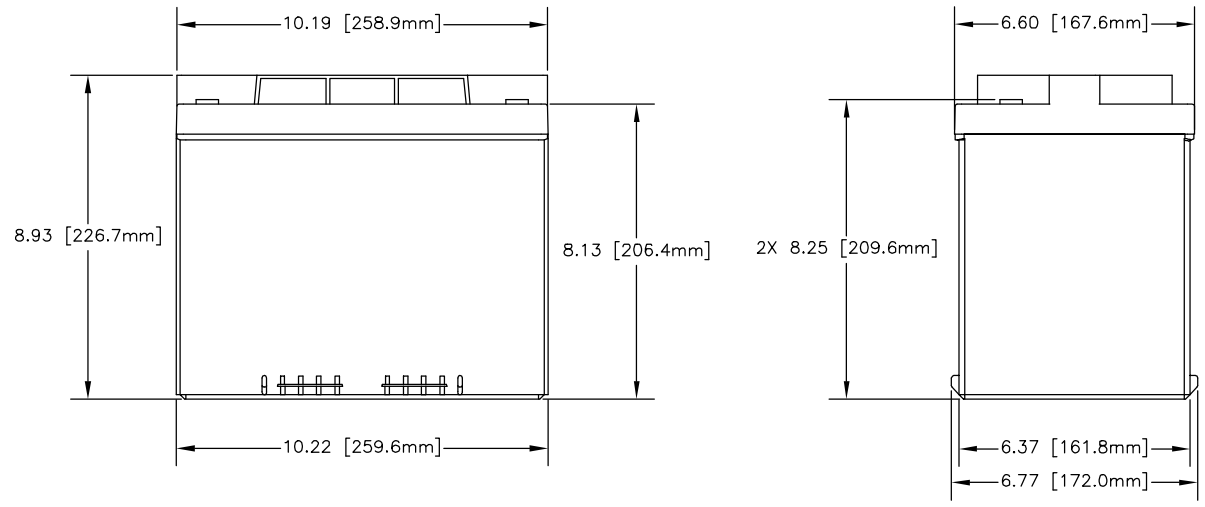
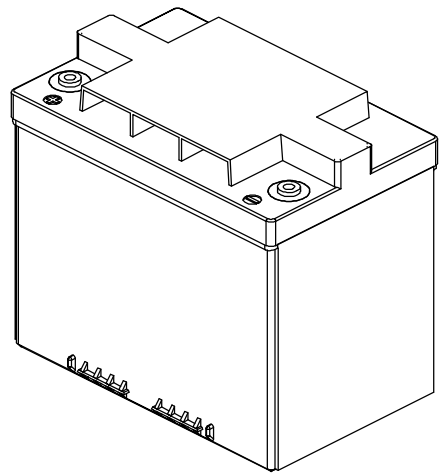
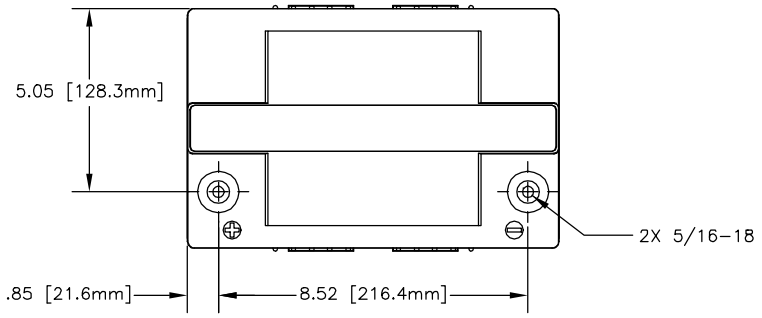

REFERENCE VIEW

ENVELOPE DRAWING

CAPACITY RATE		
PART NUMBER	AGM-1265T	AGM-1280T
NOMINAL WEIGHT	50 LBS [22.7 KG]	56 LBS [25.4 KG]
AMPERE HOUR CAPACITY @ 20 HOUR 1.75 VOLTS/CELL @ 77°F (25°C)	65 AH	80 AH
MINUTES OF DISCHARGE @ 25 AMPS 1.75 VOLTS/CELL @ 77°F (25°C)	121 MIN	149 MIN

QTY REQD	CAGE CODE	PART OR IDENTIFYING NO.	NOMENCLATURE OR DESCRIPTION	MATERIAL SPECIFICATION	ITEM NO.
PARTS LIST					
UNLESS OTHERWISE SPECIFIED DIMENSIONS ARE IN INCHES TOLERANCES ARE: FRACTIONS DECIMALS ANGLES .XX ± .06 .XXX ± .060		CONTRACT NO.		CONCORDE BATTERY CORPORATION 2009 SAN BERNARDINO RD, W. COVINA, CA 91790	
APPROVALS		DATE		TITLE	
DRAWN ELH		03/01/00		BATTERY, 12 VOLT, AGM-1280T SERIES	
TREATMENT NONE		CHECKED S. VALDEZ		03/01/00	
FINISH NONE		APPROVED JBT		03/04/00	
SIMILAR TO NA		ACT WT NA		DLC WT NA	
ISSUED DR		03/23/00		SCALE NONE	
SIZE C		CAGE CODE 63017		DWG NO. AGM-1280T	
REV A		SHEET 1 OF 1			

ENGINEERING COPY 23MAR00